

**SLOKY**<sup>®</sup>

[www.sloky.com.tw](http://www.sloky.com.tw)



***Torque  
Screwdriver***

**SLOKY**<sup>®</sup>

CHIEN FU ENTERPRISE CO.,LTD.  
No.8, Lane195,Fu Ying Road,  
Xinzhuang Dist, New Taipei City. Taiwan R.O.C

TEL : +886-2-2903-2212  
FAX : +886-2-2903-2192  
<http://www.chienfu.com>  
<http://www.sloky.com.tw>



Distributor

# About Us

“SLOKY®” comes from the meaning of “SOLO KEY” in Taiwanese dialogue. It is defined from the position of patented adapter in torque screwdriver system as a solo performer. Patented adapter plays as a solo performer, with a unique feature to build whole product system. The torque’s value is setting on the adapter; complied with various bits and handles become torque screwdrivers for tighten or loosen the screw. Sloky torque screwdriver, a predicable, replaceable and organized tool. It is considering to be used in industrial field having a greatest advantage of “no-over tighten”. It prevents the damages of the screw and tool, in addition it provides a replaceable function to fit with driver bits having different shape and dimensions.



- 
- ✓ 1. Fasten or loosen the screws quickly
  - ✓ 2. Ergonomically refine design
  - ✓ 3. Torque accuracy  $\pm 0\%$
  - ✓ 4. Color recognition

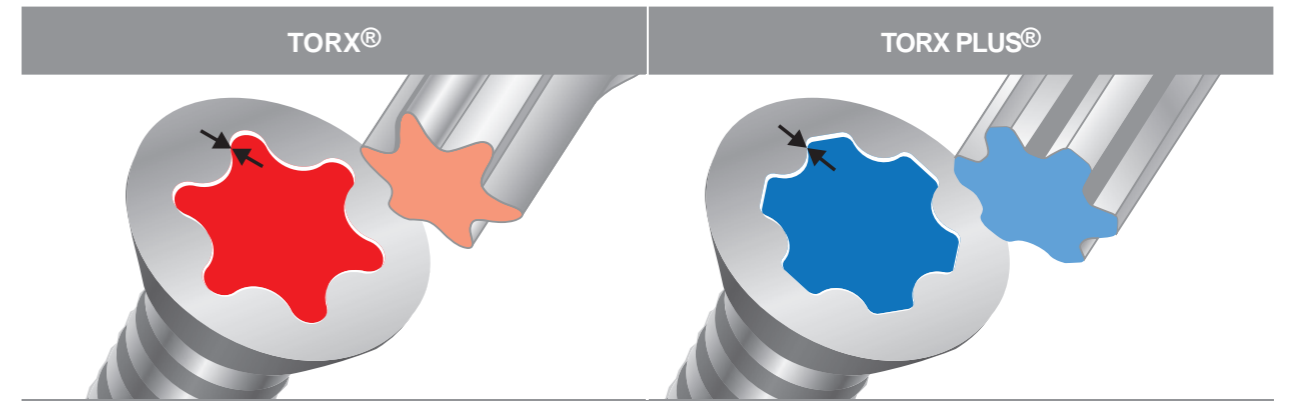

What's the difference between TORX® and TORX PLUS® bits?

TORX® and TORX PLUS® both are registered trademarks of Acument global technologies LLC. TORX® profile is widely using in latest industrial and high performance quality products. TORX PLUS® featuring elliptical configuration, larger cross section, wide contact surface to get the maximum torque to transfer and reduce the bit wear and tear. For centre-lock screws on cutting tools present a typical use of TORX PLUS® screw profile.

## A Secure hold you'll never second-guess

A precision torque tool is only as good as its results. With proper testing equipment and system, we can ensure you never have to question our products accuracy and quality.

### SCHATZ® ANALYSIS / The precise laboratory system

Schatz AG of Germany torque testing equipment.



▲ Rockwell Hardness tester



# Adapter

## Principle

"No- over tighten" adapter is created from the non-return ratchet torque socket. It comprised a shaft rod and a shaft cylinder.

A core shaft of shaft rod is sleeved with a mobile ratchet capable of axially moving; the shaft cylinder has a shaft slot formed for being sleeved with the core shaft.

When the core shaft rotates in the shaft slot and the applied torque exceeds the preset torque value, the core shaft idly rotates in the shaft slot.

It means when the demand torque is reached, continued tightening is no longer to increase the torque on the screw.

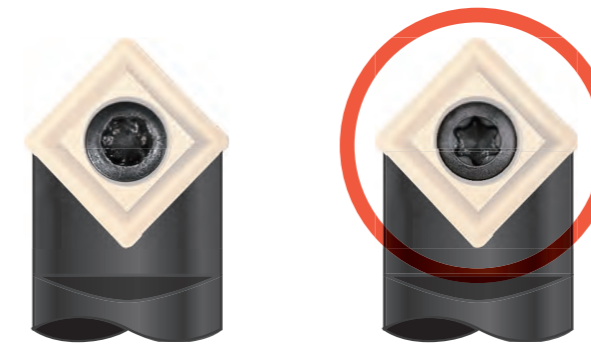
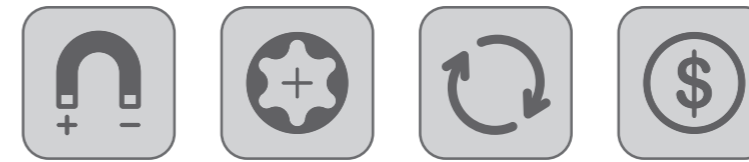

Used Screwdriver  
Without Torque

Used Screwdriver  
With Torque

Material : Carbon Steel  
Hardness : HRC 43° ~ 48°  
Surface Treatment : Electroless Nickel  
Unit conversion : 1 Nm = 10.20kgf-cm

Installed with magnet

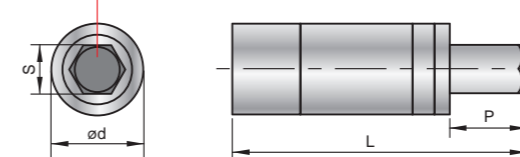

Part No.	Suit For	Ød	S	P	L	Nm	KgfcM	In-lb		N.W	Packaging Illustration
TSD-12-TX6	TX6 / 6IP	12	6.35	10	37	0.6	6.1	5.3	3 pcs		
TSD-12-TX7	TX7 / 7IP	12	6.35	10	37	0.9	9.2	8.0	3 pcs		
TSD-12-TX8	TX8 / 8IP	12	6.35	10	37	1.2	12.0	10.6	3 pcs		
TSD-12-TX9	TX9 / 9IP	12	6.35	10	37	1.4	14.0	12.4	3 pcs		
TSD-12-TX10	TX10 / 10IP	12	6.35	10	37	2.0	20.4	17.7	3 pcs		
TSD-12-TX15	TX15 / 15IP	12	6.35	10	37	3.0	30.6	26.6	3 pcs		
TSD-12-TX20	TX20 / 20IP	12	6.35	10	37	5.0	51.0	44.3	3 pcs		
TSD-12-TX25	TX25 / 25IP	12	6.35	10	37	5.5	56.1	48.7	3 pcs		

✓ 20,000times product life test

⚠ This product is only suitable for manual operation. Do not apply with other electric tools or power tools.



# Handle



## Features

We offer **3** different types of handle for your options.

The soft zone is comfortable to hold and play very flexible. Easy to tighten and loosen screws even in higher torque range.

The outstanding design of the SLOKY handle that fits perfectly into the hand and prevents the hand injuries such as blisters and calluses.

✓ *The ergonomic design of the handle*



### Universal Handle

Features :

- Universal type for holding in multi-ways.
- Having large support surfaces for thumb and index finger ease of using and efficiency.
- Remaining the advantages of flag design, driving the screw easily.

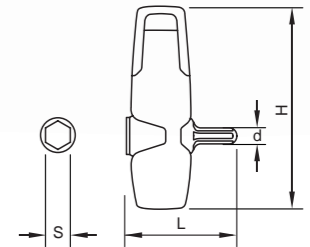

Fig	Parts No.	Suit For Torque	Color	S	L	H	d	N.W.
1	TRF	0.6-3.0 Nm	Red	6.35	70.7	37.5	5	25g

### Slim-Fit Handle

Features :

- Slim fit for comfortable holding, for accurate and efficient while fastening and loosening small sizes screws

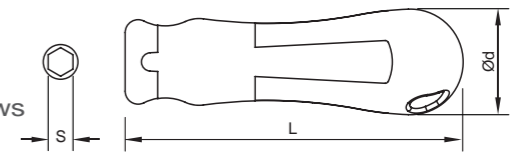

Fig	Parts No.	Suit For Torque	Color	S	L	Ød	N.W.
2	SRBJ	0.6-2.0 Nm	Red	6.35	104	32.5	45g

### T Flying Handle

Features :

- It is light, even it is designed for higher torque.
- The striking soft zone that allows particularly comfortable, best handle for using at higher troque.

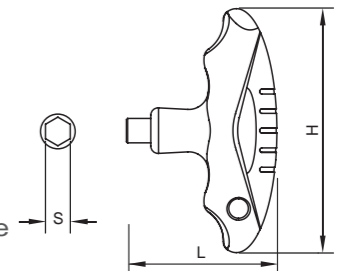
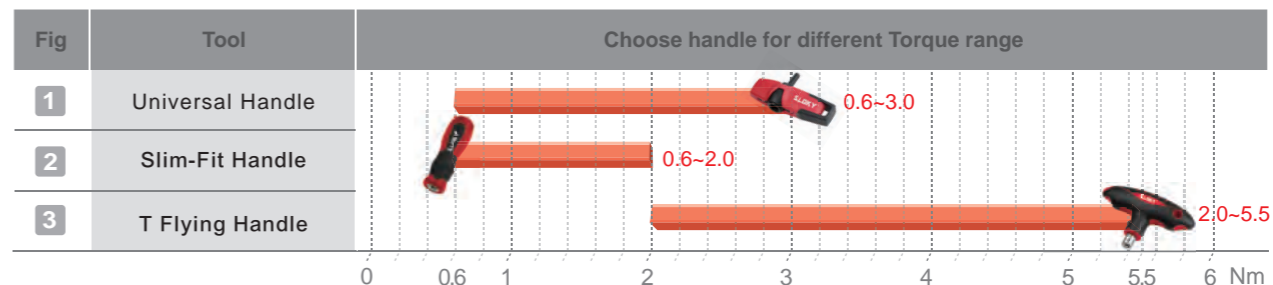

Fig	Parts No.	Suit For Torque	Color	S	L	H	N.W.
3	TRJ	2.0-5.5 Nm	Red	6.35	6.5	10	59g





# Bits

## Color Identity

No mistake!  
The color identification is visible on both adapters and bits.  
Select suitable torque size by color management system indicated on torque adapters and bits.  
It is to enhance the convenience of using and delivery proper tightening torque.



TORX®



TORX PLUS®



Tools created from ideas

**TORX®**

- TORX® drive between tool and screw by line or surface contact rather than point contact.
- It also increases the amount of torque and force that can be transferred.



## Spare

**25mm Bits for TORX® screws**  
Hardness : HRC 58° ~60°  
Material : High alloy steel  
Standard : 1/4" DIN3126 – C6.3; DIN3126-E6.3

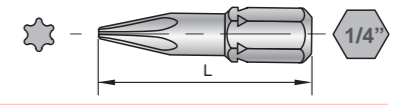

Parts No.	Driver Size	L		N.W.	Packaging Illustration
BIT25-TX6	TX6	25	6 pcs	31 g	
BIT25-TX7	TX7	25	6 pcs	31 g	
BIT25-TX8	TX8	25	6 pcs	31 g	
BIT25-TX9	TX9	25	6 pcs	31 g	
BIT25-TX10	TX10	25	6 pcs	31 g	
BIT25-TX15	TX15	25	6 pcs	33 g	
BIT25-TX20	TX20	25	6 pcs	33 g	

**50mm Bits for TORX® screws**  
Hardness : HRC 58° ~60°  
Material : High alloy steel  
Standard : 1/4" DIN3126 – C6.3; DIN3126-E6.3

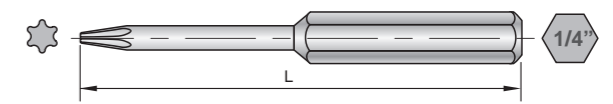

Parts No.	Driver Size	L		N.W.	Packaging Illustration
BIT50-TX6	TX6	50	6 pcs	53 g	
BIT50-TX7	TX7	50	6 pcs	53 g	
BIT50-TX8	TX8	50	6 pcs	53 g	
BIT50-TX9	TX9	50	6 pcs	55 g	
BIT50-TX10	TX10	50	6 pcs	58 g	
BIT50-TX15	TX15	50	6 pcs	59 g	
BIT50-TX20	TX20	50	6 pcs	62 g	
BIT50-TX25	TX25	50	6 pcs	62 g	

TORX® and TORX PLUS® are registered trademarks of Acument global technologies LLC.

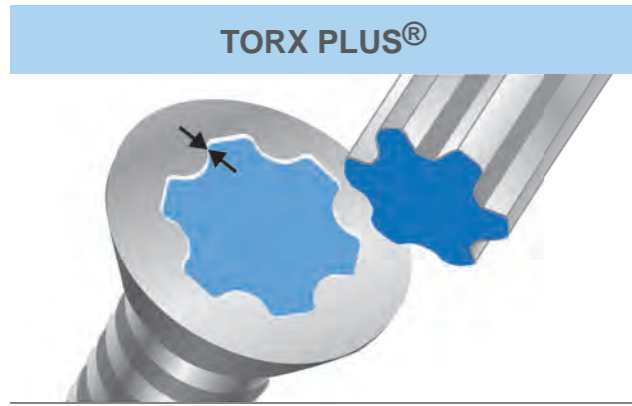

TORX PLUS®

- Larger contact surface between tool and screw.
- The line of effective force is in the direction of movement (direction of rotation).

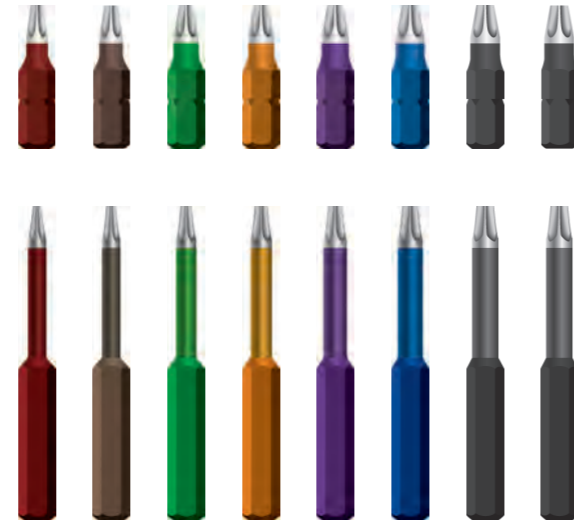

# Spare

## 25mm Bits for TORX PLUS® screws

Hardness : HRC 58° ~60°  
 Material : High alloy steel  
 Standard : 1/4" DIN3126 - C6.3; DIN3126-E6.3

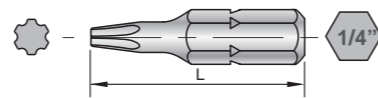

Parts No.	Driver Size	L		N.W.	Packaging Illustration
BIT25-6IP	6IP	25	6 pcs	31 g	
BIT25-7IP	7IP	25	6 pcs	31 g	
BIT25-8IP	8IP	25	6 pcs	31 g	
BIT25-9IP	9IP	25	6 pcs	31 g	
BIT25-10IP	10IP	25	6 pcs	31 g	
BIT25-15IP	15IP	25	6 pcs	33 g	
BIT25-20IP	20IP	25	6 pcs	33 g	

## 50mm Bits for TORX PLUS® screws

Hardness : HRC 58° ~60°  
 Material : High alloy steel  
 Standard : 1/4" DIN3126 - C6.3; DIN3126-E6.3

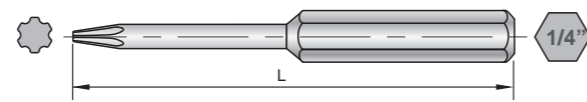

Parts No.	Driver Size	L		N.W.	Packaging Illustration
BIT50-6IP	6IP	50	6 pcs	53 g	
BIT50-7IP	7IP	50	6 pcs	53 g	
BIT50-8IP	8IP	50	6 pcs	53 g	
BIT50-9IP	9IP	50	6 pcs	55 g	
BIT50-10IP	10IP	50	6 pcs	58 g	
BIT50-15IP	15IP	50	6 pcs	59 g	
BIT50-20IP	20IP	50	6 pcs	62 g	
BIT50-25IP	25IP	50	6 pcs	62 g	

TORX® and TORX PLUS® are registered trademarks of Acument global technologies LLC.

HEXAGON



- Embout de tournevis a profil hexagonale externe



# Spare

## 25mm bits for Hexagon screws

Hardness : HRC 58° ~ 60°  
 Material : High alloy steel  
 Standard : 1/4" DIN3126 - C6.3; DIN3126-E6.3

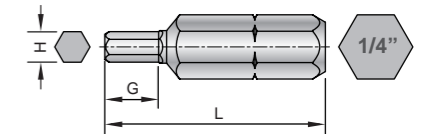

Parts No.	Driver Size	H (mm)	G (mm)	L (mm)		N.W.	Packaging Illustration
BIT25-H02	H2	2	4	25	6 pcs	33 g	
BIT25-H03	H3	3	4.5	25	6 pcs	34 g	
BIT25-H04	H4	4	6	25	6 pcs	35 g	

## 50mm bits for Hexagon screws

Hardness : HRC 58° ~ 60°  
 Material : High alloy steel  
 Standard : 1/4" DIN3126 - C6.3; DIN3126-E6.3

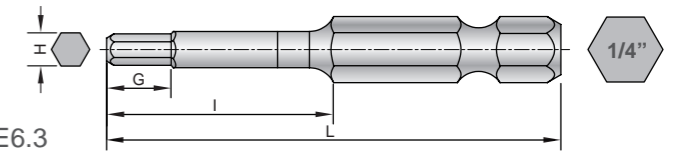

Parts No.	Driver Size	H (mm)	G (mm)	I (mm)	L (mm)		N.W.	Packaging Illustration
BIT50-H02	H2	2	4	25	50	6 pcs	52 g	
BIT50-H03	H3	3	4.5	25	50	6 pcs	57 g	
BIT25-H04	H4	4	6	25	50	6 pcs	61 g	



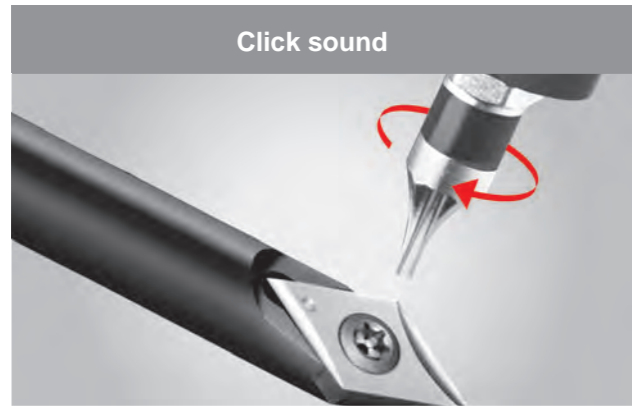

Click sound

- Let « CLICK » Tell You When The Torque Is Reached !
- Quick release !



# Smart Kit

Torque Screwdriver for TORX® Kit, 25mm Bits

Parts No.	Contents						N.W.	Packaging Illustration
	Handle	Adapter				Bit		
		Size	Nm	KgfcM	In-lb	25mm		
TSD-01	TRF	TX6	0.6	6.1	5.3	1pc	290g	
		TX7	0.9	9.2	8.0	1pc		
		TX8	1.2	12.0	10.6	1pc		
		TX9	1.4	14.0	12.4	1pc		
		TX10	2.0	20.4	17.7	1pc		
		TX15	3.0	30.6	26.6	1pc		

Torque Screwdriver for TORX PLUS® Kit, 50mm Bits

Parts No.	Contents						N.W.	Packaging Illustration
	Handle	Adapter				Bit		
		Size	Nm	KgfcM	In-lb	25mm		
TSD-01-IP	TBF	6IP	0.6	6.1	5.3	1pc	290g	
		7IP	0.9	9.2	8.0	1pc		
		8IP	1.2	12.0	10.6	1pc		
		9IP	1.4	14.0	12.4	1pc		
		10IP	2.0	20.4	17.7	1pc		
		15IP	3.0	30.6	26.6	1pc		

TORX® and TORX PLUS® are registered trademarks of Acument global technologies LLC.

This product is only suitable for manual operation. Do not apply with other electric tools or power tools.

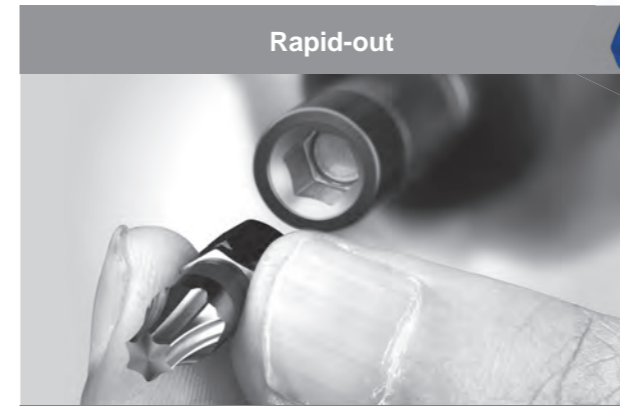

Rapid-out

- Simply pull the bit outward to change new bit.
- Perfect positioning in the bits.

# Togo Kit

Torque Screwdriver for TORX® Kit, 25mm+50mm Bits

Parts No.	Contents						N.W.	Packaging Illustration
	Handle	Adapter				Bit		
		Size	Nm	KgfcM	In-lb	25mm+50mm		
TSD-10	TRF + SRBJ	TX6	0.6	6.1	5.3	1 pc + 1 pc	437g	
		TX7	0.9	9.2	8.0	1 pc + 1 pc		
		TX8	1.2	12.0	10.6	1 pc + 1 pc		
		TX9	1.4	14.0	12.4	1 pc + 1 pc		
		TX10	2.0	20.4	17.7	1 pc + 1 pc		
		TX15	3.0	30.6	26.6	1 pc + 1 pc		

Torque Screwdriver for TORX PLUS® Kit, 25mm+50mm Bits

Parts No.	Contents						N.W.	Packaging Illustration
	Handle	Adapter				Bit		
		Size	Nm	KgfcM	In-lb	25mm+50mm		
TSD-10-IP	TRF + SRBJ	6IP	0.6	6.1	5.3	1 pc + 1 pc.	437g	
		7IP	0.9	9.2	8.0	1 pc + 1 pc		
		8IP	1.2	12.0	10.6	1 pc + 1 pc		
		9IP	1.4	14.0	12.4	1 pc + 1 pc		
		10IP	2.0	20.4	17.7	1 pc + 1 pc		
		15IP	3.0	30.6	26.6	1 pc + 1 pc		

TORX® and TORX PLUS® are registered trademarks of Acument global technologies LLC.

This product is only suitable for manual operation. Do not apply with other electric tools or power tools.

# Single Set

Single Set

## Torque Screwdriver for TORX® Single Set, 25mm+50mm Bits

Parts No.	Handle	Contents					N.W.	Packaging Illustration
		Adapter			Bit			
		Nm	KgfcM	In-lb	尺寸	25mm+50mm		
TSD-06-TX6	SRBJ	0.6	6.1	5.3	TX6	1 pcs + 1 pcs	124g	
TSD-06-TX7		0.9	9.2	8.0	TX7	1 pcs + 1 pcs		
TSD-06-TX8		1.2	12.0	10.6	TX8	1 pcs + 1 pcs		
TSD-06-TX9		1.4	14.0	12.4	TX9	1 pcs + 1 pcs		
TSD-06-TX10		2.0	20.4	17.7	TX10	1 pcs + 1 pcs		
TSD-06-TX15		3.0	30.6	26.6	TX15	1 pcs + 1 pcs		
TSD-03-TX6	TRF	0.6	6.1	5.3	TX6	2 pcs + 2 pcs	124g	
TSD-03-TX7		0.9	9.2	8.0	TX7	2 pcs + 2 pcs		
TSD-03-TX8		1.2	12.0	10.6	TX8	2 pcs + 2 pcs		
TSD-03-TX9		1.4	14.0	12.4	TX9	2 pcs + 2 pcs		
TSD-03-TX10		2.0	20.4	17.7	TX10	2 pcs + 2 pcs		
TSD-03-TX15		3.0	30.6	26.6	TX15	2 pcs + 2 pcs		
						Bit 50mm		
TSD-11-TX10	TRJ	2.0	20.4	17.7	TX10	4 pcs	196g	
TSD-11-TX15		3.0	30.6	26.6	TX15	4 pcs		
TSD-11-TX20		5.0	51.0	44.3	TX20	2 pcs		
					TX25	2 pcs		

## Torque Screwdriver for TORX PLUS® Single Set, 25mm+50mm Bits

Parts No.	Handle	Contents					N.W.	Packaging Illustration
		Adapter			Bit			
		Nm	KgfcM	In-lb	尺寸	25mm+50mm		
TSD-06-6IP	SRBJ	0.6	6.1	5.3	TX6	1 pcs + 1 pcs	124g	
TSD-06-7IP		0.9	9.2	8.0	TX7	1 pcs + 1 pcs		
TSD-06-8IP		1.2	12.0	10.6	TX8	1 pcs + 1 pcs		
TSD-06-9IP		1.4	14.0	12.4	TX9	1 pcs + 1 pcs		
TSD-06-10IP		2.0	20.4	17.7	TX10	1 pcs + 1 pcs		
TSD-06-15IP		3.0	30.6	26.6	TX15	1 pcs + 1 pcs		
TSD-03-6IP	TRF	0.6	6.1	5.3	TX6	2 pcs + 2 pcs	124g	
TSD-03-7IP		0.9	9.2	8.0	TX7	2 pcs + 2 pcs		
TSD-03-8IP		1.2	12.0	10.6	TX8	2 pcs + 2 pcs		
TSD-03-9IP		1.4	14.0	12.4	TX9	2 pcs + 2 pcs		
TSD-03-10IP		2.0	20.4	17.7	TX10	2 pcs + 2 pcs		
TSD-03-15IP		3.0	30.6	26.6	TX15	2 pcs + 2 pcs		
						Bit 50mm		
TSD-11-10IP	TRJ	2.0	20.4	17.7	TX10	4 pcs	196g	
TSD-11-15IP		3.0	30.6	26.6	TX15	4 pcs		
TSD-11-20IP		5.0	51.0	44.3	TX20	2 pcs		

TORX® and TORX PLUS® are registered trademarks of Acument global technologies LLC.

⚠ This product is only suitable for manual operation. Do not apply with other electric tools or power tools.

# User Guide

Attention

## The tips of using different handle



Large support areas for thumb and index finger on the ergonomically shaped handles.

The Slim Fit handle has been designed to fit snugly in your hand, making blisters and calluses a thing of the past, even after intensive use.

The T Flying handle is needed whenever particularly high torque for loosening or tightening jobs needs to be applied.

The transmission of high torques is thus quite simple. Cylindrical handle shaft for quick turning of screws.

The handle hard zones allow the hand to easily glide during hand repositioning. The soft zones ensure full force transfer through the grip.

The power is transferred positively, there is no frictional loss between the hand and the handle.

## Simple operation

## Exchange bits system with colour coding

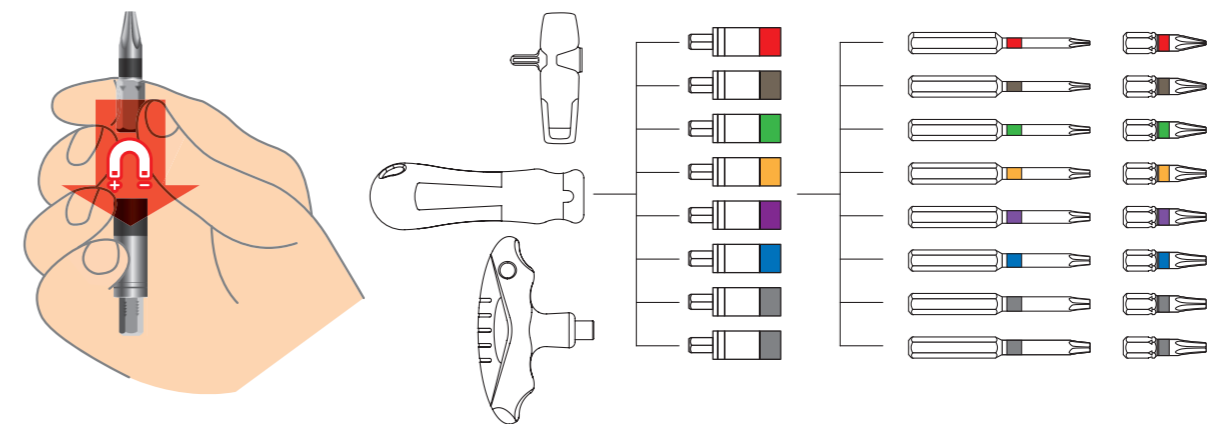

All adapters with magnetic, the bits can be inserted and automatically locked into the adapters.

## Why the torque may get low after use a certain time?

## How to judge?

The torque adapter is functional by the radial direction friction; it is different from the marketed product nowadays.

When an object slips or is going slip with another object, on the two contact faces will create a relative action. This relative action is called the static friction, it creates the abrasion after use a certain time. The preset torque of adapter may get low due to this abrasion.

- +/-10% allowance for torque adapter is acceptable.
- Please check it on Torque analyzer or measurement.

